

Threaded thermocouple form C

with neck tube, pipe sensor 14 x 2,5 mm

Measuring insert 1 x Fe-CoNi / 2x Fe-CoNi, reversible 8 mm Ø
 1 x NiCr-Ni / 2x NiCr-Ni, reversible 8 mm Ø
 Transducer installation possible (see sheet 18.10)

Connection head Form B of light alloy according to DIN 43729 with
 M 20 x 1.5 cable gland

Connection diagram See sheet 19.20

Operating temperature according to chart sheet 1.1

Response time in water 0,4 m/s: $t_{0,5} \approx 40s$, $t_{0,9} \approx 120s$
(Average value) in air 1m/s: $t_{0,5} \approx 2,5min$, $t_{0,9} \approx 7,8min$

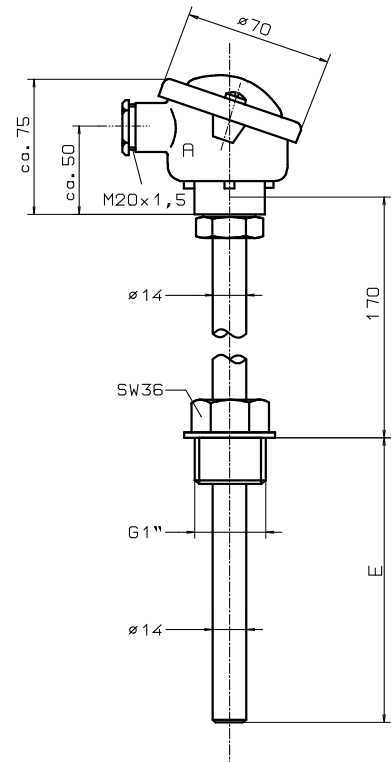

Version Sensor tube according to Form C , Thermowell 14 x 2,5 mm,
 Material 1.4541 stainless steel (V2A) X6 CrNiTi 1810

Thermowell Material	Install. Length in mm	Weight in kg	Measuring insert length	Order no.		Order no.		Delivery time
				1 x Fe-CuNi	2 x Fe-CuNi	1 x NiCr-Ni	2 x NiCr-Ni	
1.4541	100	1,2	255	1.12.04.41	1.12.04.42	2.12.04.41	2.12.04.42	Delivery at short notice after arranging possibly
	160	1,3	315	1.12.04.11	1.12.04.12	2.12.04.11	2.12.04.12	
	250	1,4	405	1.12.04.21	1.12.04.22	2.12.04.21	2.12.04.22	
	300	1,5	455	1.12.04.51	1.12.04.52	2.12.04.51	2.12.04.52	
	400	1,7	555	1.12.04.31	1.12.04.32	2.12.04.31	2.12.04.32	
	500	1,8	655	1.12.04.61	1.12.04.62	2.12.04.61	2.12.04.62	
	600	1,9	755	1.12.04.71	1.12.04.72	2.12.04.71	2.12.04.72	
	800	2,2	955	1.12.04.81	1.12.04.82	2.12.04.81	2.12.04.82	
	1000	2,5	1155	1.12.04.91	1.12.04.92	2.12.04.91	2.12.04.92	

Version Sensor tube according to Form C , Thermowell 14 x 2,5 mm,
 Material 1.4571 stainless steel (V4A) CrNiMoTi17122

Thermowell Material	Install. length in mm	Weight in kg	Measuring insert length	Order no.		Order no.		Delivery time
				1 x Fe-CuNi	2 x Fe-CuNi	1 x NiCr-Ni	2 x NiCr-Ni	
1.4541	100	1,2	255	1.12.20.41	1.12.20.42	2.12.20.41	2.12.20.42	Delivery at short notice after arranging possibly
	160	1,3	315	1.12.20.11	1.12.20.12	2.12.20.11	2.12.20.12	
	250	1,4	405	1.12.20.21	1.12.20.22	2.12.20.21	2.12.20.22	
	300	1,5	455	1.12.20.51	1.12.20.52	2.12.20.51	2.12.20.52	
	400	1,7	555	1.12.20.31	1.12.20.32	2.12.20.31	2.12.20.32	
	500	1,8	655	1.12.20.61	1.12.20.62	2.12.20.61	2.12.20.62	
	600	1,9	755	1.12.20.71	1.12.20.72	2.12.20.71	2.12.20.72	
	800	2,2	955	1.12.20.81	1.12.20.82	2.12.20.81	2.12.20.82	
	1000	2,5	1155	1.12.20.91	1.12.20.92	2.12.20.91	2.12.20.92	