

## Fast response threaded thermocouple

<b>Measuring insert</b>	permanently installed thermocouples Fe-CuNi or NiCr-Ni In special design with exchangeable measuring insert Transducer mounting possible (see sheet 18.10)		
<b>Connection head</b>	Form B of light alloy according to DIN 43729 with M 20 x 1.5 cable gland		
<b>Connection diagram</b>	See sheet 19.20		
<b>Operating temperature</b>	to 800 ° C at the tip		
<b>Response time</b>	in water 0,4 m/s:	$t_{0,5} \approx 20s$	$t_{0,9} \approx 60s$
<b>(Average value)</b>	in air 1m/s:	$t_{0,5} \approx 2min$	$t_{0,9} \approx 6min$

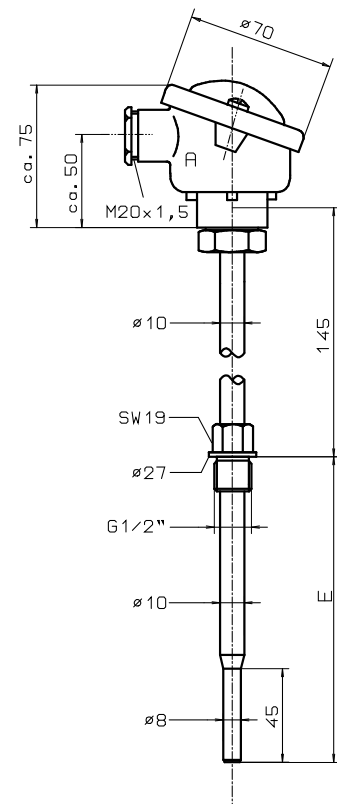

**Version** Material 1.4541 stainless steel (V2A) X6 CrNiTi 1810

Thermowell Material	E in mm	Weight in kg	Order no. 1 x Fe-CuNi	Order no. 2 x Fe-CuNi	Order no. 1 x NiCr-Ni	Order no. 2 x NiCr-Ni	Delivery time
1.4541	100	0,9	1.32.04.51	1.32.04.52	2.32.04.51	2.32.04.52	Delivery at short notice after arranging possibly
(V2A)	160	1,0	1.32.04.11	1.32.04.12	2.32.04.11	2.32.04.12	
	200	1,0	1.32.04.61	1.32.04.62	2.32.04.61	2.32.04.62	
	250	1,1	1.32.04.21	1.32.04.22	2.32.04.21	2.32.04.22	
	300	1,2	1.32.04.91	1.32.04.92	2.32.04.91	2.32.04.92	
	350	1,3	1.32.04.71	1.32.04.72	2.32.04.71	2.32.04.72	
	400	1,4	1.32.04.31	1.32.04.32	2.32.04.31	2.32.04.32	
	500	1,5	1.32.04.81	1.32.04.82	2.32.04.81	2.32.04.82	

Other nominal lengths possible

**Version** Material 1.4571 stainless steel (V4A) CrNiMoTi17122

Thermowell Material	E in mm	Weight in kg	Order no. 1 x Fe-CuNi	Order no. 2 x Fe-CuNi	Order no. 1 x NiCr-Ni	Order no. 2 x NiCr-Ni	Delivery time
1.4571	100	0,9	1.32.20.51	1.32.20.52	2.32.20.51	2.32.20.52	Delivery at short notice after arranging possibly
	160	1,0	1.32.20.11	1.32.20.12	2.32.20.11	2.32.20.12	
	200	1,0	1.32.20.61	1.32.20.62	2.32.20.61	2.32.20.62	
	250	1,1	1.32.20.21	1.32.20.22	2.32.20.21	2.32.20.22	
	300	1,2	1.32.20.91	1.32.20.92	2.32.20.91	2.32.20.92	
	350	1,3	1.32.20.71	1.32.20.72	2.32.20.71	2.32.20.72	
	400	1,4	1.32.20.31	1.32.20.32	2.32.20.31	2.32.20.32	
	500	1,5	1.32.20.81	1.32.20.82	2.32.20.81	2.32.20.82	

Other nominal lengths possible